

Entering / Browsing / Borrowing

Entering

Available for academic research and study purposes.
Please fill out the application form at the service counter.
*Please bring identification.

Browsing

The Medical Library holds specialized academic materials in the fields of medicine, dentistry, pharmacy, and nursing. Anyone can browse and make copies of materials, not only those affiliated with Kyushu University.

Some databases and provided or contracted by Kyushu University are also available. Please apply at the service counter.

Borrowing

Only alumni of the hospital district and medical professionals in the prefecture may borrow materials.
A library card is required to borrow materials, so please apply at the service counter.
*It cannot be issued on the same day.

Period: 14 days for books, 7 days for magazines
Limit : 3 items

Materials below are in-library use only :
reference books, rare books and audio-visual materials

Returning

Please return library materials at the circulation desk.
If you have not returned by the due date, your borrowing privilege will be suspended.
When the library is closed, the book drop on the left side of the entrance is available.

Library Catalog

■ Collections
<https://catalog.lib.kyushu-u.ac.jp/en>



'Collections' is a search platform of Kyushu University materials.
You can search for library holdings both in print and electronic formats.

Please mind your manners in the Library

- ◆ Return items to their proper shelf locations after reading.
- ◆ Be quiet and do not disturb other users.
- ◆ Do not leave your wallet and other valuables in the seat.
- ◆ Calls are allowed only at the cell phone booth on the 2nd floor.
- ◆ Eating outside of the 1st floor Browsing Room is prohibited.

Light Meals, Drinks Without Lid	Bottled Drinks & Canteens
 Allowed Only in the Browsing Room	 Allowed

Ask A Librarian

Circulation Section

TEL:092-642-6037 FAX: 092-642-6041
E-mail: tieetura@jimu.kyushu-u.ac.jp

Inter-Library Loan Section

TEL : 092-642-6039 FAX: 092-642-6041
E-mail: tirsougo@jimu.kyushu-u.ac.jp

Reference Section

TEL: 092-642-6040 FAX: 092-642-6041
E-mail: tiasanko@jimu.kyushu-u.ac.jp

Acquisition & Cataloging Section

TEL: 092-642-6035 FAX: 092-642-6041
E-mail: tiuukemo@jimu.kyushu-u.ac.jp

〒812-8582 Maidashi, 3-1-1, Higashi-ku, Fukuoka
<https://www.lib.kyushu-u.ac.jp/en/libraries/medical>

Kyushu University Medical Library

Information (for visitors) 2025

■ Opening Hours

Monday - Friday 9:00~21:00
Sat, Sun, and National Holidays 9:30~17:00

■ Closed

Aug.12 - 17
Dec.27, 2025 - Jan.4, 2026

Please check the library website about temporary closure and shortened opening hours.

Use of Facilities and Materials

Research

Study and Reading Rooms are available for browsing materials in the library.
Group Study Rooms and Individual Study Rooms are not available.
You may eat food and have drinks at The Browsing Room.

PC

There are 2 computers (Chromebox) available in the e-learning and audiovisual booth.

*Application is required for use.

Copy Machine

There are 2 copy machines in the library (self-service).

*Reproduction in libraries is subject to legal limitation. You are allowed to make copies only when it is for non-profit use, single-copy per capita, and the number of copies is less than half of total pages of the items.

Floor Maps

1F

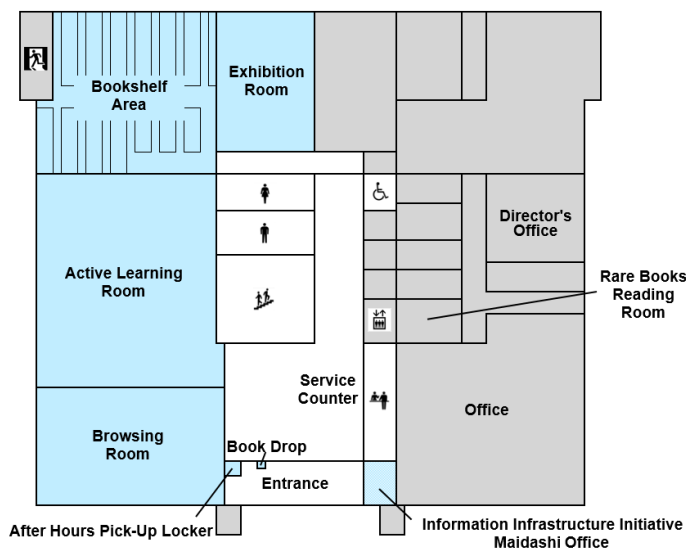

2F

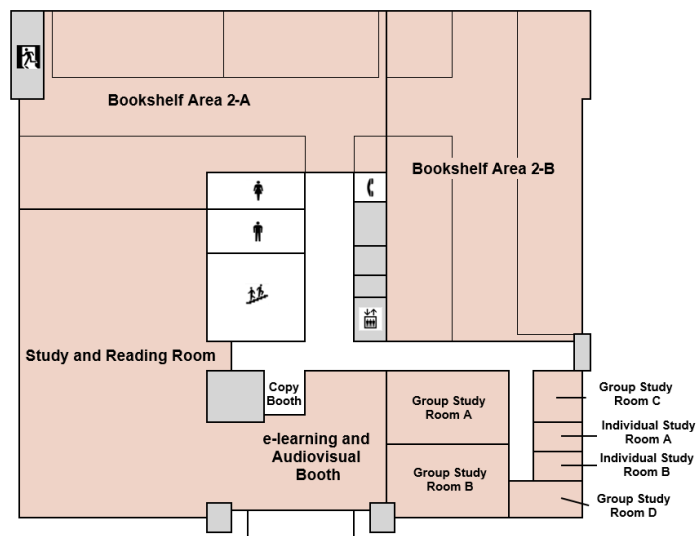

3F

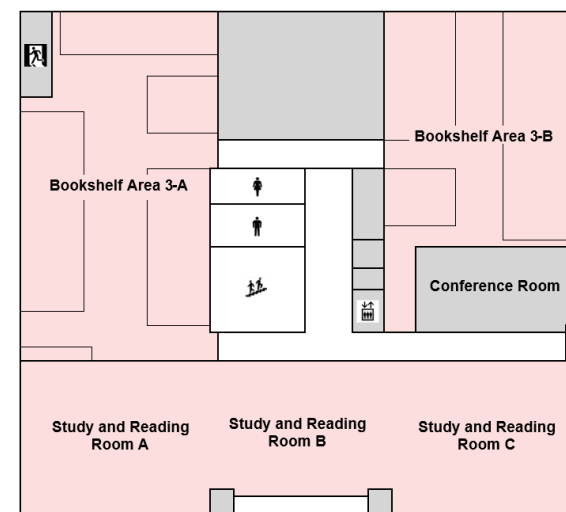

Search terminals

Search terminals are located throughout the library.

Mail Order

A mailing service for photocopies of materials is available (for a fee). Please contact the section below to make a request.
If you want to request for book interlibrary loan, please apply through your local public library.

Inter-Library Loan Section
TEL : 092-642-6039
E-mail: tirsougo@jimu.kyushu-u.ac.jp

Reference

We will assist you in researching documents related to our collection. However, time-consuming research may be denied.
Requests can be made by e-mail, telephone, or at the Reference Desk.

Reference Section
TEL : 092-642-6040
E-mail: tiasanko@jimu.kyushu-u.ac.jp

Shelf Guides

The Medical Library's materials are mainly journals and specialized books in the fields of medicine, dentistry, pharmacy, nursing science and their adjacent areas.
Medical books are classified by the National Library of Medicine Classification System (NLMC).

Floor	Location	Materials
1F	Bookshelf Area	Books for Students Corner Books Reference Books
2F	Bookshelf Area 2-A	Japanese Journals A-Z Foreign Journals A
	Bookshelf Area 2-B	Foreign Journals A-J
3F	Bookshelf Area 3-A	Books Collections
	Bookshelf Area 3-B	Foreign Journals K-Z